

no.	by	description	date
-	-	Issued For Permit & Construction	6/03/09
-	-	Issued For Client Review	3/24/09

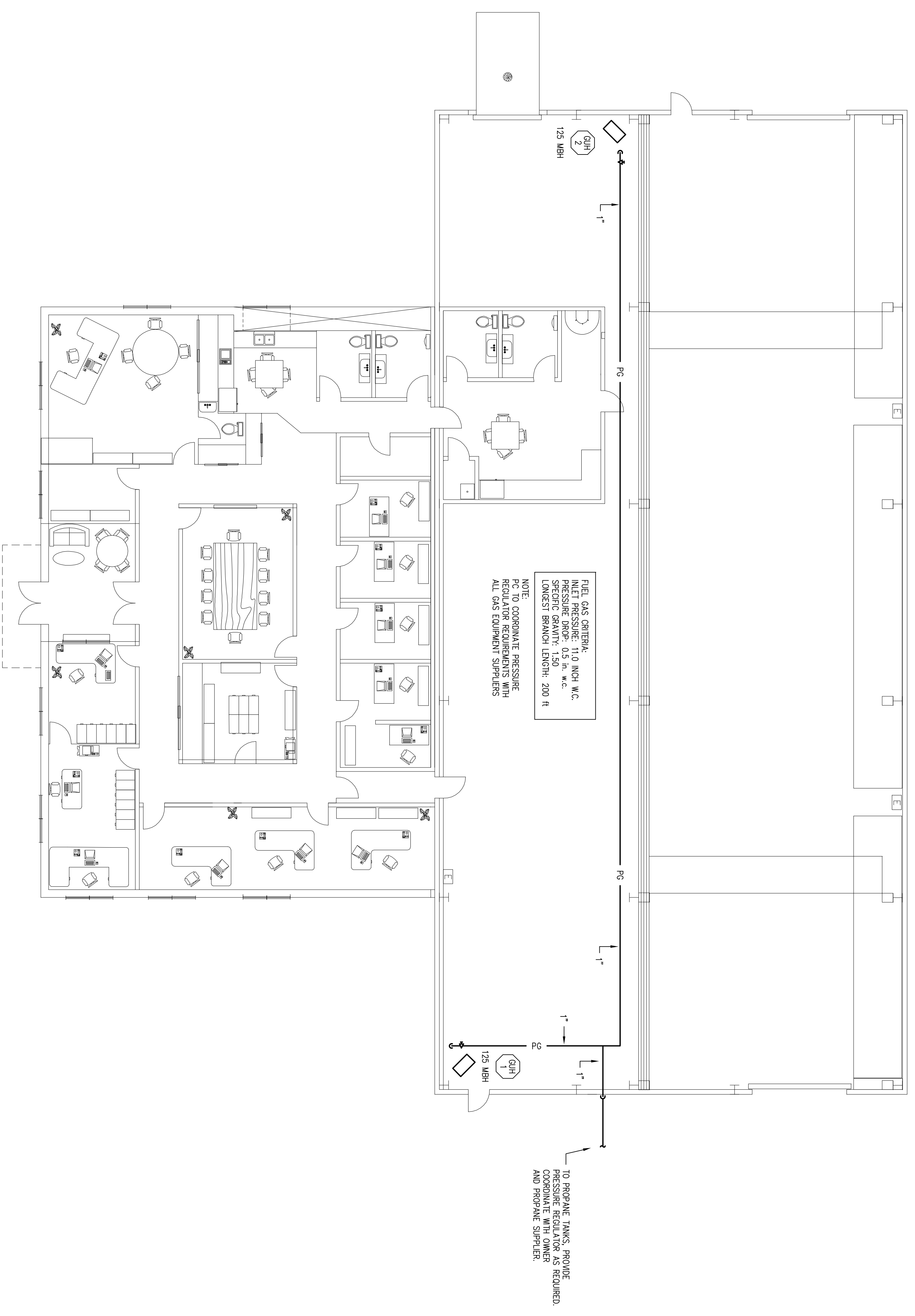

**New Shop & Office Building for
 Shupper-Brickle Equipment Co.
 11 Burnt Tavern Road
 Millstone Township, NJ 08535
 Block: 57
 Lot: 14.01**

BRIAN D. TANNENHAUS

NJ PROFESSIONAL ENGINEER
 NO. GE 45801
 DATE: June 3, 2009

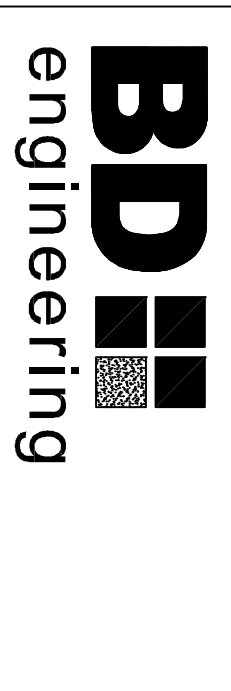

NJ CERTIFICATE OF AUTHORIZATION - 240A28115100
 BD Engineering, LLC 732-886-5432
 1825 Swarthmore Ave. Lakewood, NJ 08701
 Project No. 080056

DRAWN BY:	CHECKED BY:	SCALE:
RS	BT	1/8"=1'0"

FUEL GAS PLAN

DRAWING NO. P4.1